



ENVIRO

G SERIES



RESIDENTIAL



- Design service life of **100 years** for fixed parts + 25 years for servicable parts
- Made using 'green concrete' **reducing carbon emission by more than 80%** when compared to other materials
- Internal components manufactured from **high grade stainless steel**, complying with International Corrosion Standards. No welding necessary
- The safest solution with **no confined space entry** required
- Installation is simple and prompt without the need for site closure + with minimal disruption
- Enviro systems are self ballasting + are fully structural

Speak to one of Enviro's friendly Engineers today



Shone +61 427 648 489
Digin +61 419 785 289



info@enviroaustralis.com.au



PO BOX 34, Angaston, South Australia 5353



**GOOD
DESIGN
AWARD®
WINNER**



ENVIRO

G SERIES

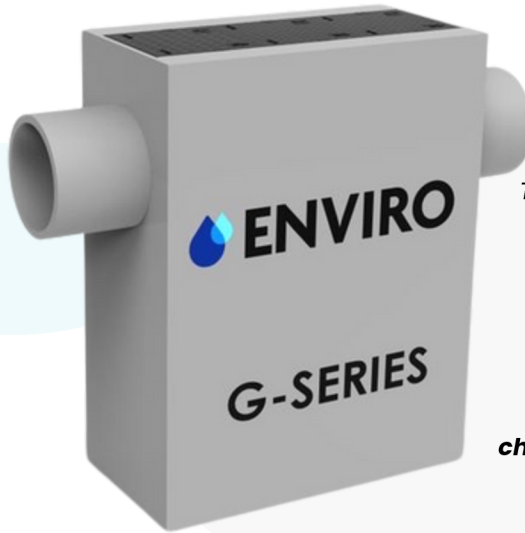
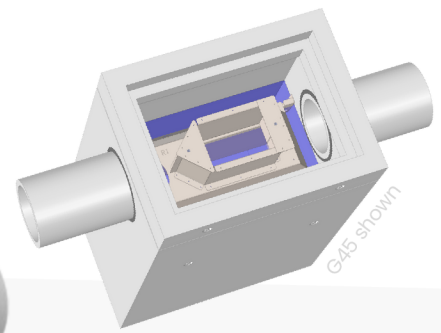

The Enviro G Series is an in-line single chamber EPS designed to remove broad spectrum pollutants that are transported by stormwater run-off in **low impact catchments**, which are typically residential developments.

The G Series is a **low-cost single chamber device** with separate storage zone that replaces the need for a treatment train.

“Enviro systems ensure the highest compliance at the lowest cost.”

Enviro systems are:

- 45% lower cost to install
- 87% lower cost to maintain
- 77% lower cost to own over 25 years

compared to alternative systems.

Enviro's 'green concrete' chambers *cut carbon emissions by over 80%* compared to traditional materials and are **indefinitely recyclable**.

In recent years, Enviro has *reduced CO2 emissions by 300 tonnes* and *removed 10 tonnes* of plastic from the waste stream.



Hydraulic Resistance K Factor = 0.425
Inlet to outlet differential = 25mm

Performance testing verifies pollutant removal rates:

Pollutants Reduction Claim	% Reduction (minimum requirement)	% Reduction (as tested)
Total Suspended Solids (TSS)	85%	94%
Total Phosphorous (TP)	60%	97%
Total Nitrogen (TN)	45%	85%
Oils	-	95%*
Gross Pollutants	90%	100%

*based on dual chamber capture of buoyant materials incl. oils.

Model	Pipe Size	Treated Flow + Storage Capacity	Plan Dimensions (External length + width)	Depth Below Invert	Mass	Excavation Volume
Enviro G30	Nominally 300mm ID can be used for 375mm ID subject to gradient + velocity	22 litres/sec 0.25 m ³	1.2m x 0.9m	1.2m	2.6 tonnes	1.7 m ³
Enviro G45	450mm ID	66 litres/sec 0.52 m ³	1.5m x 1.2m	1.4m	4.6 tonnes	3.3 m ³
Enviro G60	600mm ID	142 litres/sec 0.87 m ³	2.2m x 1.2m	1.8m	7.5 tonnes	6.2 m ³
Enviro G75	750mm ID	258 litres/sec 3.2 m ³	2.85m x 1.95m	2.2m	13.3 tonnes	15.9 m ³
Enviro G90	Nominally 900mm ID can be used for 1050mm pipe size subject to gradient + velocity	419 litres/sec 3.3 m ³	3.6m x 1.95m	2.0m	15.8 tonnes	18.3 m ³
Enviro G120	1200mm ID	902 litres/sec 3.0 m ³	3.6m x 2.1m	1.8m	16.3 tonnes	10.3 m ³

Speak to one of Enviro's friendly Engineers today



Shone +61 427 648 489
Digin +61 419 785 289



info@enviroaustralis.com.au